

PROJECT

**Coumragappul Wind Farm
 110kV Grid Connection**

CLIENT



CONSULTANTS

NOTES:-

- Path of cable route and location of associated Joint Bays, Link Boxes and Comms Chambers may vary depending on site conditions.
- Other services may be encountered on the route.
- This drawing is to be used only for the purpose of the planning application and is subject to detailed design.
- Final section of Cable within Dungarvan Substation to be confirmed and completed by ESB/EirGrid.

LEGEND:-

- Proposed Under Ground Cable (22.47km) shown thus
- Red Line Boundary shown thus
- River/ Lakes shown thus
- Existing Levels (m) - Datum Malin Head 86.21
- Dungarvan 110kV Substation shown thus
- Joint Bay Locations shown thus
- Temporary Works Area shown thus
- Chainage from Dungarvan 110kV Substation shown thus - 22400 m
- Landowner Boundary

ISSUE/REVISION

I/R	DATE	DESCRIPTION
P6	02.10.2023	Issued For Planning
P5	23.08.2023	Issued For Planning
P4	26.07.2023	Issued For Planning
P3	05.07.2023	Issued For Planning
P2	12.05.2023	Issued For Planning
P1	13.01.2023	Issued For Planning

PROJECT NUMBER

05-828

SHEET TITLE

Site Layout Plan
 Sheet 1 of 12

SHEET NUMBER

05828-DR-101

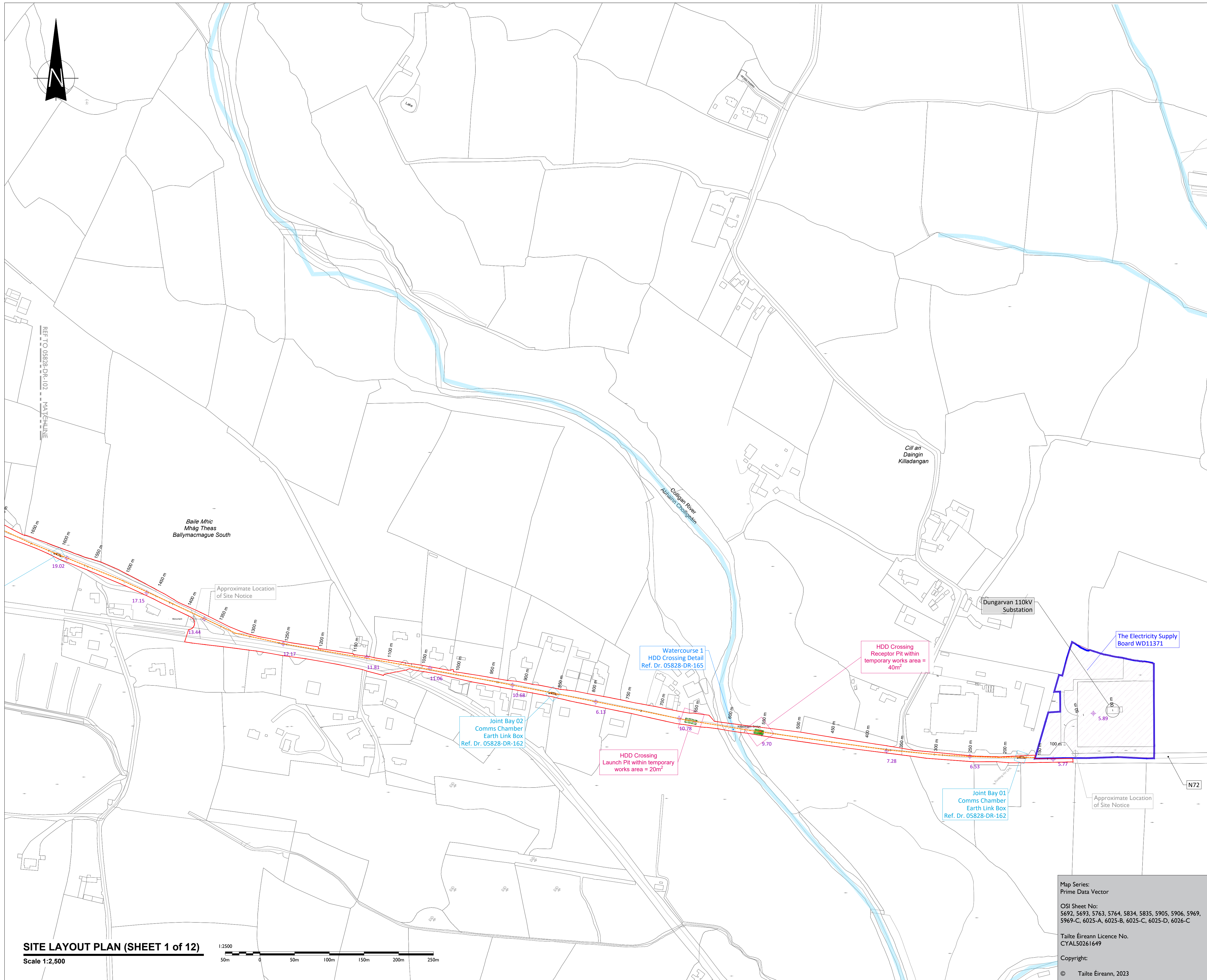

SITE LAYOUT PLAN (SHEET 1 of 12)

Scale 1:2,500

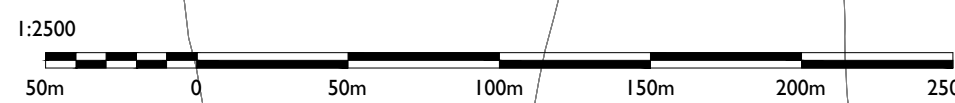

Map Series:
 Prime Data Vector

OSJ Sheet No:
 5692, 5693, 5763, 5764, 5834, 5835, 5905, 5906, 5969,
 5969-C, 6025-A, 6025-B, 6025-C, 6025-D, 6026-C

Taitte Éireann Licence No.
 CYAL50261649

Copyright:
 © Taitte Éireann, 2023